

45 AUTO (REVOLVER)

Test Specifications:

Firearm Used: Freedom Arms

Barrel Length: 7 1/2"

Twist: 1 x 16"

Components:

Case: Starline

Trim-to Length: 0.893"

Primer: Fed 150

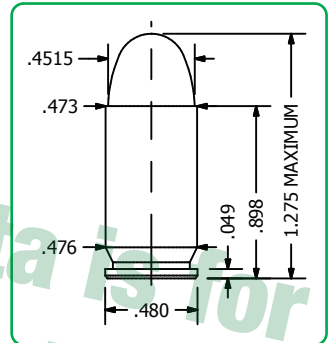



Remarks:

When a person thinks of a 45 ACP, they naturally think of a 1911 type semiauto pistol. Surprisingly though, there have been several revolvers chambered in 45 ACP along with the Thompson Center Contender. When the U.S. entered into the First World War, the Army was in dire need of side arms. The rimless 45 ACP was the military cartridge being used at that period. In 1917, Smith and Wesson produced the Model 1917 Army Model 45 using three shot half moon clips, which allowed the rimless 45 ACP case to headspace correctly, load quickly as well as ejected simultaneously and the clips were reusable. Smith and Wesson made 153,311 of these revolvers for the US Military, while Colt made 151,700 of the Colt New Service revolver, which also used the half moon clips.

In addition, Colt and Remington Arms-Union Metallic Cartridge Company made another 438,000. Smith and Wesson also made an additional 25,000 for the Government of Brazil. Even some of the British Webleys were adapted to use the half moon clips. The 45 ACP has always been a popular cartridge for self and home defense, plus it is very popular as Pin Guns (for bowling pins) because of the large diameter bullet and controllable recoil. Smith and Wesson still offers the Model 625 (which can be used with or without clips) and Taurus offers a Model 455. Full moon clips (which holds all 5 or 6 rounds, depending on what the revolver requires) are available now. A different twist though is the Freedom Arms Model 83 Casull, which we used for data for this cartridge. This is a single action revolver which does not use half or full moon clips, but is loaded one round at a time in true single action fashion. This is the same revolver that the 454 Casull is chambered in and is a much stouter revolver than the S&W or Taurus.

All loads listed are safe for all the revolvers listed but ARE NOT SUITABLE FOR USE IN THE SEMI AUTOS. A normal taper crimp rather than a roll crimp which is normally used on revolver cartridges.

45 AUTO (REVOLVER)



Bullet Caliber Weight Type		C.O.A.L.						
	#8800 .4515" 185gr. JHP	1.212"						
	#8810 .4515" 185gr. FPJ Match	1.155"						
Powder ∨	Velocity >	1000	1050	1100	1150	1200	1250	1300
Titegroup		5.5	6.2	6.9	7.6	8.2	8.9	9.6
American Select		5.1	5.6	6.1	6.6	7.0	7.5	8.0
Zip		6.8	7.1	7.3	7.6	7.8	8.1	8.3
Viht N330		6.6	6.9	7.2	7.5	7.8	8.1	8.4
Unique		6.7	7.2	7.6	8.1	8.5	9.0	9.4
Univ. Clays		6.2	6.6	6.9	7.3	7.6	8.0	8.3
Power Pistol		7.2	7.7	8.1	8.6	9.0	9.5	9.9
Silhouette		7.9	8.3	8.7	9.1	9.4	9.8	10.2
Viht N340		7.2	7.5	7.8	8.1	8.3	8.6	8.9
WSF		7.1	7.5	7.8	8.2	8.6	8.9	9.3
Viht 3N37		8.3	8.7	9.0	9.4	9.7	10.1	10.4
Energy Ft. lbs		411	453	497	543	591	642	694
Special Load	Powder	Grains	Velocity fps	Energy Ft. lb				
Accuracy Load	Univ. Clays	8.0	1250	642				
Hunting Load	Unique	9.4	1300	694				

45 AUTO (REVOLVER)

Bullet Caliber Weight Type								C.O.A.L.
	#8825 .4515" 200gr. FPJ Match							1.155"
Powder v	Velocity >	950	1000	1050	1100	1150	1200	
Titegroup		5.2	5.6	5.9	6.3	6.6	7.0	
American Select		5.2	5.7	6.1	6.6	7.0	7.5	
Zip		6.0	6.3	6.7	7.0	7.4	7.7	
Viht N330		6.5	6.8	7.1	7.4	7.7	8.0	
Unique		6.7	7.0	7.3	7.7	8.0	8.3	
Univ. Clays		6.2	6.5	6.7	7.0	7.2	7.5	
Power Pistol		6.9	7.3	7.7	8.1	8.5	8.9	
Silhouette		7.7	8.0	8.4	8.7	9.1	9.4	
Viht N340		7.1	7.3	7.6	7.8	8.1	8.3	
WSF		6.8	7.2	7.5	7.9	8.2	8.6	
Viht 3N37		8.0	8.3	8.6	8.8	9.1	9.4	
Energy Ft. lbs		401	444	490	537	587	639	
Special Load	Powder	Grains	Velocity fps	Energy Ft. lb				
Accuracy Load	WSF	8.2	1150	587				
Hunting Load	Zip	7.7	1200	639				

Do not edit or redistribute.

45 AUTO (REVOLVER)

Bullet		Caliber	Weight	Type	C.O.A.L.	
	#8815	.4515"	230gr.	FMJ Match	1.270"	
	#8805	.4515"	230gr.	JHP	1.210"	

Powder ▾	Velocity >	900	950	1000	1050	1100
Titegroup		5.2	5.5	5.8	6.1	6.4
American Select		4.9	5.4	5.9	6.4	6.9
Zip		5.4	5.8	6.2	6.6	7.0
Viht N330		6.0	6.4	6.8	7.1	7.5
Unique		5.3	5.9	6.5	7.0	7.6
Univ. Clays		5.6	6.0	6.3	6.7	7.0
Power Pistol		7.6	7.8	7.9	8.1	8.2
Silhouette		6.9	7.3	7.6	8.0	8.3
WSF		6.5	6.9	7.3	7.6	8.0
Viht 3N37		7.6	7.9	8.2	8.5	8.8
Energy Ft. lbs		414	461	511	563	618

Special Load	Powder	Grains	Velocity fps	Energy Ft. lb
Accuracy Load	Viht N330	7.1	1050	563
Hunting Load	WSF	8.0	1100	618

45 AUTO (REVOLVER)

Bullet		Caliber	Weight	Type	C.O.A.L.	
		#8820	.4515"	240gr.	JHC	1.200"
Powder	Velocity	900	950	1000	1050	1100
American Select		5.0	5.5	6.0	6.5	7.0
Zip			5.6	6.1	6.6	
Viht N330		5.8	6.2	6.6	6.9	7.3
Unique		6.1	6.5	6.9	7.2	7.6
Univ. Clays		5.6	6.0	6.3	6.7	7.0
Power Pistol			7.7	7.9	8.1	8.3
Silhouette		6.6	7.1	7.5	8.0	8.4
WSF		6.4	6.8	7.2	7.6	8.0
Viht 3N37		7.7	8.0	8.3	8.5	8.8
Energy Ft. lbs		432	481	533	587	645
Special Load	Powder	Grains	Velocity fps	Energy Ft. lb		
Accuracy Load	Unique	7.2	1050	587		
Hunting Load	Univ. Clays	7.0	1100	645		

Do not edit or redistribute.