

45 AUTO (ACP) +P**Test Specifications:**

Firearm Used: Universal

Barrel Length: 5"

Twist: 1-16"

Components:

Case: Starline

Trim-to Length: 0.893

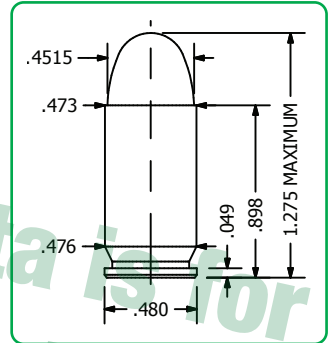

Primer: WLP

**Remarks:**



The following load data should only be used in firearms that are marked for use with +P ammunition. Please proceed with caution and care. Be very diligent to adhere to the load specifications. Cartridge comments can be found on the parent cartridge page.

Do not edit or
redistribute.



45 AUTO (ACP) +P

Bullet Caliber Weight Type		C.O.A.L.						
	#8800 .4515" 185gr. JHP	1.212"						
	#8810 .4515" 185gr. FPJ Match	1.155"						
Powder ∨	Velocity >	750	850	950	1050	1100	1150	1200
Clays		4.9	5.5	6.1				
Bullseye		5.0	5.8	6.6	6.9			
Target			5.6	6.4	6.8	7.2		
Tite Group		4.9	5.6	6.4	6.7			
American Select	4.8	5.4	6.0	6.5				
WST	4.7	5.3	6.0					
N320	5.2	5.7	6.3	6.9				
A#2		5.3	6.0	6.6				
Zip		6.2	6.9	7.5	7.8			
Win 231		5.7	6.5	7.2	7.6			
Unique		6.0	6.7	7.5	7.8			
Power Pistol		6.5	7.3	8.0	8.4	8.8		
Sport Pistol			6.2	6.9	7.2			
Herco			6.9	7.6	7.9			
N340				7.8	8.1			
True Blue				8.5	9.1	9.6		
A#5				9.7	10.2	10.7		
Auto Comp				7.5	8.2	8.6	9.0	
Silhouette		7.8	8.5	9.3	9.6	10.0		
A#7		9.9	10.9	11.8	12.2	12.7	13.2	
Energy Ft. Lbs		231	297	371	453	497	543	591
Special Load	Powder	Grains	Velocity fps	Energy Ft. lb				
Accuracy Load	A#2	6.6	1050	453				
Hunting Load	A#7	13.2	1200	591				

45 AUTO (ACP) +P

Bullet		Caliber	Weight	Type	C.O.A.L.						
	#8825	.4515"	200gr.	FPJ Match	1.155"						
	#9820	.4515"	200gr.	JHP V-Crown	1.210"						
Powder	Velocity	650	750	850	950	1000	1050	1100			
Clays				4.5	5.1	5.5					
Bullseye				5.0	5.6	6.0	6.3				
Target				4.8	5.6	6.0	6.3				
Tite Group				4.8	5.5	5.8					
American Select	4.2	4.7	5.2	5.7	6.0						
WST	4.5	5.2	5.8								
N320	5.0	5.5	6.1	6.3							
A#2	4.0	4.6	5.2	5.7							
Zip	5.5	6.1	6.8	7.1	7.4						
Win 231	5.2	5.9	6.5	6.8							
Unique	5.2	5.8	6.4	6.7							
Power Pistol			6.3	7.2	7.6	8.0	8.4				
Sport Pistol			5.3	6.0	6.3						
Herco				6.8	7.1	7.4					
WSF				6.7	7.0	7.4					
True Blue			6.7	7.6	8.0	8.4					
A#5				8.6	9.0	9.5	10.0				
Auto Comp			6.6	7.3	7.7	8.1	8.5				
Silhouette			7.4	8.0	8.4	8.7	9.0				
A#7				10.2	10.8	11.3	11.9				
Energy Ft. Lbs	188	250	321	401	444	490	537				
Special Load	Powder	Grains	Velocity fps	Energy Ft. lb							
Accuracy Load	N320	6.3	1000	444							
Hunting Load	Power Pistol	8.4	1100	537							

45 AUTO (ACP) +P

Bullet		Caliber	Weight	Type	C.O.A.L.				
	#8805	.4515"	230gr.	JHP	1.210"				
	#8815	.4515"	230gr.	FMJ Match	1.270"				
Powder	Velocity	600	700	800	850	900	950	1000	
Clays		3.9	4.5	4.7					
Bullseye		4.2	4.8	5.2	5.5				
Target			4.7	5.0	5.4	5.7			
Tite Group			4.6	4.9	5.3				
American Select		4.3	4.9	5.2					
WST		4.4	5.0	5.3					
N320			5.1	5.4					
Zip			5.7	6.1	6.4				
Win 231	4.3	4.9	5.5	5.8	6.0				
Unique			5.5	5.8	6.1				
Power Pistol			6.1	6.5	6.9	7.2			
Sport Pistol			5.1	5.4	5.7				
Herco			5.9	6.2	6.5	6.8			
WSF			5.6	5.9	6.2	6.6			
N340			5.9	6.1	6.4	6.7			
True Blue				6.8	7.2	7.7			
A#5				7.7	8.2	8.7			
Auto Comp			6.2	6.5	6.9	7.2			
Silhouette			6.7	7.1	7.4	7.8	8.1		
A#7				9.0	9.4	9.9	10.3		
Energy Ft. Lbs		184	250	327	369	414	461	511	
Special Load	Powder	Grains	Velocity fps	Energy Ft. lb					
Accuracy Load	Power Pistol	7.2	950	461					
Hunting Load	Silhouette	8.1	1000	511					

45 AUTO (ACP) +P

Bullet		Caliber	Weight	Type	C.O.A.L.				
	#8820	.4515"	240gr.	JHC	1.185"				
Powder	Velocity	600	650	700	750	800	850	900	
Clays		3.7	4.0	4.2	4.5				
Bullseye					4.5	4.8	5.1		
Target				4.2	4.5	4.9	5.2	5.6	
Tite Group					4.4	4.7	5.0		
American Select		4.1	4.3	4.6	4.9				
WST		3.9	4.2	4.5					
N320			4.6	4.9	5.2				
A#2		3.9	4.2	4.5					
Zip						5.6	5.9		
Win 231					5.1	5.5	5.8		
Unique					5.0	5.3	5.6		
Power Pistol					5.6	6.0	6.4	6.8	
Sport Pistol					4.7	5.0	5.3		
Herco		4.7	5.1	5.4	5.7	6.0	6.3		
WSF		4.8	5.1	5.3	5.6	5.9	6.2		
N340	4.6	4.9	5.2	5.5	5.8	6.1	6.4		
True Blue			5.6	6.0	6.4	6.8	7.2		
A#5				6.7	7.2	7.6	8.1		
Auto Comp		5.0	5.3	5.7	6.0	6.3	6.7		
Silhouette						7.0	7.3		
A#7						8.6	9.0	9.5	
Energy Ft. Lbs		192	225	261	300	341	385	432	
Special Load	Powder	Grains	Velocity fps	Energy Ft. lb					
Accuracy Load	Zip	5.9	850	385					
Hunting Load	Target	5.6	900	432					