

# 9mm LARGO

## Test Specifications:

Firearm Used: Star Super

Barrel Length: 5.150"

Twist: 1 x 16"

## Components:

Case: Starline

Trim-to Length: 0.900"

Primer: WSP

## Remarks:

Although virtually unheard of until recently, the 9mm Largo is not a new cartridge. Developed in the early 1900's as a military pistol cartridge, it was adopted by the Danish (Model 1910) and Spanish (Star and Astra) military. Also known as a 9mm Bayard, Bergman, Bergman Bayard, Bayard Long, Danish, and 9 x 23, the Largo is almost exactly like the popular 38 Super except being rimless and having a deeper extractor groove.



9x23 and 9mm Super Comp dies will work to load the Largo. The 9x21 dies will work if you will back them up slightly. The surplus ammo available is all berdan primed, but for the reloader, Starline makes cases specifically for the 9mm Largo.

Due to the deep extractor groove, 9mm shell plates and shell holders won't work well. In the Dillon, we found the #3 shell plate (.222, .223, etc.) With #3 buttons worked well on the Model 550 and the #23 shell holder in the RCBS.

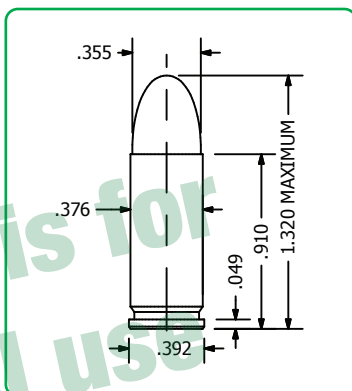
One observation in the Star we tested and others we examined was the diameter of the firing pin hole being exceptionally large, allowing the primer to flow back into the opening. We suggest using primers with hard cups such as Winchester or CCI to prevent this from occurring.





## 9mm LARGO

		Bullet	Caliber	Weight	Type	C.O.A.L.		
		#8100	.355"	90gr.	JHP	1.190"		
		#9990	.355"	90gr.	JHP V-Crown	1.190"		
Powder	Velocity	> 1200	1250	1300	1350	1400	1450	1500
Bullseye		5.1	5.4	5.7	6.0	6.3	6.6	6.9
231		5.2	5.5	5.8	6.2	6.5	6.8	7.1
A #5		7.5	7.9	8.3	8.6	9.0		
Univ. Clays		5.8	6.0	6.2	6.4	6.6	6.8	7.0
HS 6		8.4	8.7	8.9	9.2	9.4	9.7	9.9
Power Pistol		6.3	6.6	7.0	7.3	7.6	8.0	8.3
Viht 3N37		7.3	7.5	7.7	7.9	8.1	8.3	8.5
A #7		9.2	9.6	10.0	10.3	10.7	11.1	
<b>Energy Ft. lbs</b>		<b>288</b>	<b>312</b>	<b>338</b>	<b>364</b>	<b>392</b>	<b>420</b>	<b>450</b>
Special Load	Powder	Grains	Velocity fps	Energy Ft. lb				
<b>Accuracy Load</b>	Viht 3N37	8.1	1400	392				
<b>Hunting Load</b>	Power Pistol	8.0	1450	420				

		Bullet	Caliber	Weight	Type	C.O.A.L.		
		#8105	.355"	95gr.	FMJ Match	1.200"		
Powder	Velocity	> 1150	1200	1250	1300	1350	1400	1450
Bullseye		4.9	5.2	5.5	5.8	6.0	6.3	6.6
231		5.2	5.5	5.8	6.1	6.4	6.7	7.0
A #5		7.3	7.8	8.2	8.7	9.1		
Univ. Clays		5.6	5.8	6.0	6.2	6.4	6.6	6.8
HS 6		8.1	8.4	8.6	8.9	9.1	9.4	9.6
Power Pistol		6.4	6.7	7.0	7.3	7.5	7.8	8.1
Viht 3N37		6.9	7.1	7.4	7.6	7.8	8.1	8.3
A #7		8.5	9.0	9.5	9.9	10.4	10.9	
<b>Energy Ft. lbs</b>		<b>279</b>	<b>304</b>	<b>330</b>	<b>356</b>	<b>384</b>	<b>413</b>	<b>443</b>
Special Load	Powder	Grains	Velocity fps	Energy Ft. lb				
<b>Accuracy Load</b>	Viht 3N37	8.1	1400	413				
<b>Hunting Load</b>	Bullseye	6.6	1450	443				

# 9mm LARGO

	Bullet	Caliber	Weight	Type	C.O.A.L.
	#8110	.355"	115gr.	JHP	1.250"
	#8115	.355"	115gr.	FMJ Match	1.280"





Powder	Velocity	1100	1150	1200	1250	1300	1350
Bullseye	4.9	5.2	5.5	5.7	6.0		
231	5.0	5.3	5.5	5.8	6.0		
A #5	6.9	7.3	7.7	8.1	8.5	8.9	
Univ. Clays	5.0	5.3	5.6	5.9	6.2	6.5	
Power Pistol	6.2	6.5	6.9	7.2	7.6	7.9	
HS 6	7.2	7.5	7.9	8.2	8.6	8.9	
Viht 3N37	6.2	6.5	6.8	7.2	7.5	7.8	
A #7	8.7	9.1	9.6	10.0	10.4		
<b>Energy Ft. lbs</b>	<b>309</b>	<b>338</b>	<b>368</b>	<b>399</b>	<b>431</b>	<b>465</b>	

Special Load	Powder	Grains	Velocity fps	Energy Ft. lb
<b>Accuracy Load</b>	Viht 3N37	7.5	1300	431
<b>Hunting Load</b>	Univ. Clays	6.5	1350	465

Do not edit or redistribute.

# 9mm LARGO

	Bullet	Caliber	Weight	Type	C.O.A.L.		
	#9924	.335"	124gr.	JHP V-Crown	1.300"		
	#8125	.355"	125gr.	JHP	1.300"		
	#8120	.355"	125gr.	FMJ Match	1.300"		
	#9925	.335"	125gr.	JHP V-Crown	1.300"		
Powder ▾	Velocity >	1050	1100	1150	1200	1250	1300
Bullseye		4.5	4.9	5.2	5.6	5.9	
231		4.7	5.0	5.3	5.6	5.9	
A #5		6.8	7.2	7.5	7.9	8.2	8.6
Univ. Clays		5.1	5.4	5.7	5.9	6.2	6.5
Power Pistol		6.0	6.3	6.6	6.9	7.2	7.5
HS 6		6.9	7.3	7.7	8.0	8.4	
Viht 3N37		6.1	6.4	6.7	6.9	7.2	7.5
A #7		8.5	8.8	9.2	9.5	9.8	
<b>Energy Ft. lbs</b>		<b>306</b>	<b>336</b>	<b>367</b>	<b>400</b>	<b>434</b>	<b>469</b>
Special Load	Powder	Grains	Velocity fps	Energy Ft. lb			
<b>Accuracy Load</b>	Viht 3N37	7.2	1250	434			
<b>Hunting Load</b>	Viht 3N37	7.5	1300	469			