

# 38 SUPER AUTO +P

## Test Specifications:

Firearm Used: Universal

Barrel Length: 5.0"

Twist: 1-10"

## Components:

Case: Starline

Trim-to Length: 0.895"

Primer: WSR

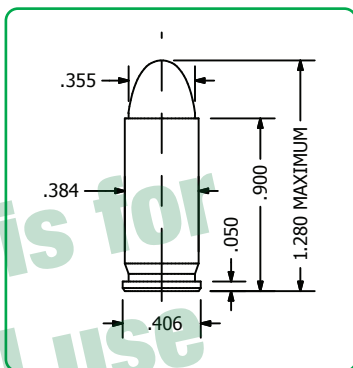



## Remarks:

The cartridge we know today as the 38 Super has its roots in the old 38 ACP. Designed by John M. Browning and introduced by Colt in a light autoloading pistol in 1900, the 38 ACP operated at a maximum average of 23,000 CUP. In 1929, the cartridge was given a substantial boost in chamber pressure and chambered in the M1911 pistol. Operating at a maximum average of 33,000 CUP, this combination was dubbed the 38 Super. Although the two are dimensionally identical, 38 Super ammunition must never be fired in the older Model 1900 and 1902 Colt pistols originally intended for the milder 38 ACP cartridge.



A semi rimmed design, the 38 Super has always had a reputation for poor accuracy. This was just one factor that dampened the Super's popularity here in the United States. The case's minuscule rim was inadequate for headspacing which caused ignition problems. In turn, the unreliable ignition was found to be the source of most of the cartridge's accuracy problems. Very little was done to correct these problems until the early 1980s when the cartridge was revived by IPSC shooters, who were interested primarily in the Super's power level. Because of the attention lavished upon it by USPSA/IPSC shooters, barrel makers such as Bar Sto Precision began to offer barrels that headspaced on the case mouth, rather than the rim. With ignition and headspace problems resolved, the Super has proven to be an extremely accurate cartridge.

Reloading the Super is not difficult but requires extraordinary caution. Loads that make "major" have become the Super's stock in trade, but they must be approached with prudence and common sense. Some of the loads being used by competitors have been tested and found to give pressures as high as 50,000 CUP! For the record, Sierra emphatically does not recommend the use of "major" loads as a steady diet for any handgun. Such loads are terribly hard on the gun and dangerous to the shooter. The 38 Super is an excellent, but highly specialized cartridge.





## 38 SUPER AUTO +P

	Bullet	Caliber	Weight	Type	C.O.A.L.			
	#8100	.355"	90gr.	JHP	1.175"			
	#9990	.355"	90gr.	JHP V-Crown	1.175"			
	#8105	.355"	95gr.	FMJ Match	1.180"			
Powder	Velocity	1300	1400	1500	1550	1600	1650	1700
Clays			5.3	5.9				
Bullseye				6.2	6.5	6.8		
Tite Group			5.5	6.0	6.3			
American Select	5.1	5.5						
Zip	6.1	6.6	7.1	7.3	7.6			
Universal				7.1	7.6			
Power Pistol						8.2	8.7	9.2
N330		6.4	6.9	7.2				
Herco		8.8	9.4	9.8				
True Blue			8.3	8.6	8.9			
A#5			9.3	9.6	9.9			
Auto Comp			7.7	8.0	8.2	8.5		
CFE Pistol			7.4	7.7	8.0	8.3		
Silhouette	5.1	5.6						
3N37			8.4	8.7	9.0	9.3		
N350			7.6	8.0	8.4	8.8		
Win 572		7.0	7.5	7.8	8.1	8.3	8.6	
A#7			10.2	10.6	11.0	11.3	11.7	
Longshot			7.6	7.9	8.2	8.5	8.8	
N105		9.7	10.6	11.0	11.4	11.8	12.2	
<b>Energy Ft. Lbs</b>		<b>338</b>	<b>392</b>	<b>450</b>	<b>480</b>	<b>512</b>	<b>544</b>	<b>577</b>
Special Load	Powder	Grains	Velocity fps	Energy Ft. lb				
<b>Accuracy Load</b>	A#7	11.7	1700	577				
<b>Hunting Load</b>	Power Pistol	9.2	1700	577				

**38 SUPER AUTO +P**

Bullet		Caliber	Weight	Type	C.O.A.L.				
	#8110	.355"	115gr.	JHP	1.215"				
	#8115	.355"	115gr.	FMJ Match	1.275"				
Powder	Velocity	1000	1100	1200	1300	1400	1450	1500	
Clays		3.9	4.5						
Bullseye				4.8	5.4				
Tite Group				4.6	5.2				
American Select	3.8	4.3	4.8						
Zip		4.8	5.4	5.9					
Win 231		4.6	5.2	5.8					
Unique					6.2	7.4	8.0	8.6	
Universal					5.9	6.4	6.7		
Power Pistol						7.1	7.4	7.7	
Herco						8.8	9.3		
True Blue					7.0	7.8	8.1		
A#5					7.7	8.3	8.6		
Auto Comp					6.6	7.2	7.5		
CFE Pistol					6.2	6.9	7.2		
Silhouette					7.0	7.5	7.7		
3N37						7.7	8.0		
N350					6.6	7.2			
Win 572					6.5	7.1	7.3		
A#7							10.0	10.4	
Longshot					6.6	7.2	7.5	7.8	
N105						9.2	9.6	10.1	
<b>Energy Ft. Lbs</b>		<b>255</b>	<b>309</b>	<b>368</b>	<b>431</b>	<b>500</b>	<b>537</b>	<b>574</b>	
Special Load	Powder	Grains	Velocity fps	Energy Ft. lb					
<b>Accuracy Load</b>	Unique	8.6	1500	574					
<b>Hunting Load</b>	Unique	8.6	1500	574					

# 38 SUPER AUTO +P

Bullet	Caliber	Weight	Type	C.O.A.L.
	#9924	.355"	124gr. JHP V-Crown	1.215"
	#8120	.355"	125gr. FMJ Match	1.275"
	#8125	.355"	125gr. JHP	1.215"
	#9925	.355"	125gr. JHP V-Crown	1.215"

Powder	Velocity	1050	1150	1200	1250	1300	1350	1400
Clays		4.4	4.7					
Bullseye				4.9	5.2	5.5		
Tite Group	4.0	4.6	4.9	5.1	5.4			
American Select	4.1	4.7	4.9					
Zip			5.7	5.9	6.2	6.4		
Win 231		5.1	5.4	5.7	6.0			
Universal		5.3	5.6	5.8	6.0	6.3		
Power Pistol			6.2	6.5	6.8	7.1	7.4	
N330		5.3	5.6	5.8	6.1			
True Blue					7.2	7.6		
A#5		7.1	7.4	7.8	8.1	8.4	8.8	
Auto Comp			6.1	6.4	6.7	7.0		
CFE Pistol					6.3	6.7		
Silhouette		6.2	6.5	6.7	7.0	7.2		
3N37			6.5	6.9	7.2	7.6		
N350		5.9	6.2	6.5	6.9	7.2		
Win 572		5.7	5.9	6.2	6.5	6.7	7.0	
A#7					8.5	8.9	9.3	9.6
Longshot		5.7	6.0	6.3	6.6	6.9	7.2	
N105						8.4	8.8	9.3
<b>Energy Ft. Lbs</b>		<b>304</b>	<b>364</b>	<b>396</b>	<b>430</b>	<b>465</b>	<b>502</b>	<b>540</b>

Special Load	Powder	Grains	Velocity fps	Energy Ft. lb
<b>Accuracy Load</b>	Power Pistol	7.4	1400	540
<b>Hunting Load</b>	Power Pistol	7.4	1400	540