

38 AUTOMATIC

Test Specifications:

Firearm Used: Universal

Barrel Length: 5.0"

Twist: 1-10"

Components:

Case: Starline

Trim-to Length: 0.895"

Primer: WSR

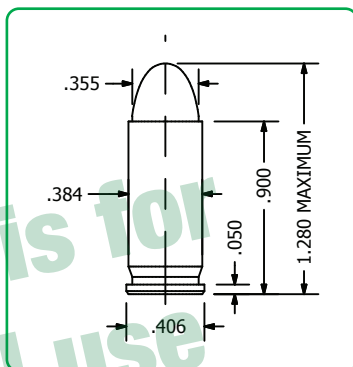



Remarks:

The 38 Automatic was designed by John Browning in 1900 and Colt introduced firearms the same year. Originally designed as a military cartridge. The cartridge became popular due to it's relatively high velocities. The military turned it down and guns have not been produced since 1928. The cartridge is obsolete and factory loadings are not available. There are several of the firearms still in use to this day.



The 38 Automatic in 1929 underwent some pressure and velocity advancements that created another cartridge. This was namely the 38 Super Automatic. NOTE: Do not confuse the data tables between the two cartridges.

Do not edit or
redistribute.





38 AUTOMATIC

| | Bullet | Caliber | Weight | Type | | | | | C.O.A.L. |
|---|----------|------------|--------------|---------------|------------|------------|------------|------------|----------|
|  | #8100 | .355" | 90gr. | JHP | | | | | 1.175" |
|  | #9990 | .355" | 90gr. | JHP V-Crown | | | | | 1.175" |
|  | #8105 | .355" | 95gr. | FMJ Match | | | | | 1.180" |
| Powder | Velocity | 1150 | 1200 | 1250 | 1300 | 1350 | 1400 | 1500 | |
| Clays | | | 3.9 | 4.2 | 4.6 | | | | |
| Bullseye | | | | | 5.0 | 5.3 | 5.6 | | |
| Tite Group | | | 4.3 | 4.6 | 4.9 | | | | |
| American Select | | 4.4 | 4.6 | 4.9 | | | | | |
| Zip | | 5.3 | 5.6 | 5.8 | 6.1 | | | | |
| Power Pistol | | | | | | 5.9 | 6.4 | | |
| N330 | | | | 5.7 | 5.9 | 6.2 | | | |
| Herco | | | | 7.8 | 8.1 | 8.4 | 8.8 | 9.4 | |
| True Blue | | | | 6.6 | 6.9 | 7.2 | 7.6 | | |
| A#5 | | | | | 8.2 | 8.5 | 8.8 | | |
| Auto Comp | | | | 6.3 | 6.6 | 6.9 | 7.2 | | |
| CFE Pistol | | | | | 6.3 | 6.6 | 6.8 | | |
| Silhouette | | 4.4 | 4.6 | 4.8 | | | | | |
| 3N37 | | | | | 7.1 | 7.4 | 7.7 | | |
| N350 | | | | | 6.0 | 6.4 | 6.8 | | |
| Win 572 | | | | 6.2 | 6.5 | 6.8 | 7.0 | | |
| A#7 | | | | | 8.8 | 9.2 | 9.5 | | |
| Longshot | | | | | 6.4 | 6.7 | 7.0 | | |
| N105 | | | | 8.5 | 8.9 | 9.3 | 9.7 | | |
| Energy Ft. Lbs | | 264 | 288 | 312 | 338 | 364 | 392 | 450 | |
| Special Load | Powder | Grains | Velocity fps | Energy Ft. lb | | | | | |
| Accuracy Load | A#7 | 9.5 | 1400 | 392 | | | | | |
| Hunting Load | Herco | 9.4 | 1500 | 450 | | | | | |

38 AUTOMATIC

| | Bullet | Caliber | Weight | Type | C.O.A.L. | | | |
|---|--------------|------------|--------------|---------------|------------|------------|------------|------------|
|  | #8110 | .355" | 115gr. | JHP | 1.215" | | | |
|  | #8115 | .355" | 115gr. | FMJ Match | 1.275" | | | |
| Powder ▾ | Velocity > | 950 | 1000 | 1050 | 1100 | 1150 | 1200 | 1300 |
| Clays | | 3.4 | 3.7 | 3.9 | | | | |
| Bullseye | | 3.6 | 3.9 | 4.2 | | | | |
| Tite Group | | 3.1 | 3.4 | 3.7 | 4.0 | | | |
| American Select | | 3.5 | 3.8 | 4.0 | | | | |
| Zip | | | | 4.5 | 4.8 | 5.1 | | |
| Win 231 | | 4.0 | 4.3 | 4.6 | | | | |
| Universal | | | | | | 5.1 | 5.3 | |
| Power Pistol | | | | | 5.1 | 5.4 | 5.7 | |
| N330 | | | | | 4.8 | 5.1 | | |
| Herco | | | | | | 6.3 | 6.8 | |
| True Blue | | | | | 5.6 | 6.0 | 6.3 | |
| A#5 | | | | | 6.6 | 6.8 | 7.1 | |
| Auto Comp | | | | | | 5.7 | 6.0 | |
| CFE Pistol | | | | | 4.9 | 5.2 | 5.6 | |
| Silhouette | | | | | | 6.2 | 6.5 | |
| 3N37 | | | | | 5.5 | 5.9 | 6.2 | |
| N350 | | | | | 5.2 | 5.5 | 5.9 | |
| Win 572 | | | | | | 5.6 | 5.9 | |
| A#7 | | | | | | | 7.6 | 8.5 |
| Longshot | | | | | 5.4 | 5.7 | 6.0 | |
| N105 | | | | | | | 7.5 | 8.4 |
| Energy Ft. Lbs | | 230 | 255 | 281 | 309 | 338 | 368 | 431 |
| Special Load | Powder | Grains | Velocity fps | Energy Ft. lb | | | | |
| Accuracy Load | Power Pistol | 5.7 | 1200 | 368 | | | | |
| Hunting Load | A#7 | 8.5 | 1300 | 431 | | | | |

38 AUTOMATIC

| Bullet | Caliber | Weight | Type | C.O.A.L. | | | | | |
|---|--------------|------------|--------------|---------------|------------|------------|------------|------------|--------|
|  | #9924 | .355" | 124gr. | JHP | V-Crown | | | | 1.215" |
|  | #8120 | .355" | 125gr. | FMJ | Match | | | | 1.275" |
|  | #8125 | .355" | 125gr. | JHP | | | | | 1.215" |
|  | #9925 | .355" | 125gr. | JHP | V-Crown | | | | 1.215" |
| Powder | Velocity | 950 | 975 | 1000 | 1050 | 1100 | 1150 | 1200 | |
| Clays | | | | | 3.9 | 4.1 | | | |
| Bullseye | | | | | 4.0 | 4.3 | | | |
| Tite Group | 3.4 | 3.6 | 3.7 | 4.0 | | | | | |
| American Select | 3.6 | 3.7 | 3.8 | | | | | | |
| Zip | | | | | 4.9 | 5.1 | 5.4 | | |
| Win 231 | 4.0 | 4.1 | 4.3 | 4.5 | | | | | |
| Unique | | | | | | 5.1 | 5.6 | | |
| Universal | | 4.5 | 4.6 | 4.8 | 5.1 | | | | |
| Power Pistol | | | | | 5.2 | 5.5 | 5.9 | | |
| N330 | | 4.4 | 4.5 | 4.8 | 5.0 | | | | |
| True Blue | | | | | | 5.9 | 6.3 | 6.6 | |
| A#5 | | | | | 6.4 | 6.8 | 7.1 | | |
| Auto Comp | | | | | 5.3 | 5.6 | 5.9 | | |
| CFE Pistol | | | | | | 4.9 | 5.2 | | |
| Silhouette | | | | | 5.7 | 5.9 | 6.2 | | |
| 3N37 | | | | | 5.4 | 5.8 | 6.1 | | |
| N350 | | | 4.9 | 5.2 | 5.5 | 5.9 | | | |
| Win 572 | | | | | 5.1 | 5.4 | 5.7 | | |
| A#7 | | | | | 6.9 | 7.3 | 7.7 | 8.1 | |
| Longshot | | | | | 5.1 | 5.4 | 5.7 | | |
| N105 | | | | | | | 7.0 | 7.5 | |
| Energy Ft. Lbs | | 248 | 262 | 275 | 304 | 333 | 364 | 396 | |
| Special Load | Powder | Grains | Velocity fps | Energy Ft. lb | | | | | |
| Accuracy Load | Power Pistol | 5.9 | 1150 | 364 | | | | | |
| Hunting Load | True Blue | 6.6 | 1200 | 396 | | | | | |